

NORTON



CS1 P13

SPARE PARTS LIST

clipper[®]

1 Spare parts list

POS.	PAGE	CODE	DENOMINATION	TYP (*)	NOTES
1	EC01	00310004899	Frame	S	
2	EC01	00310004903	Cover for water tank	S	
3	EC02	00310004747	Blade guard Ø450	S	Machine 70184624214
		00310354053	Blade guard Ø500		Machine 70184629389
4	EC02	00310004181	Nut for blade guard	S	
5	EC02		Axle for blade guard	S	
6	EC02	00310004398	Splash guard	W	
7	EC02	00310004184	Lock for water distribution	S	
8	EC02	00310004376	Tubes ,water nozzles set (2 pces)	S	
9	EC02	00310004182	T distributor	W	
10	EC02	00310004745	Water distribution	S	
12	EC02	00310002080	Hose support	W	
13	EC02	00310004180	Hose support	W	
14	EC02	00310004009	Water tap only	W	
15	EC01	00310004620	Handwheel	S	
16	EC01	00310004208	Handle	S	
17	EC01	00310004343	Flange bearing	W	
18	EC01	00310004682	Screw raise and lower	W	
19	EC01	00310004681	Tube raise and lower	W	
20	EC01	00310004619	Bearing (set of 2)	W	
21	EC01	00310004683	Pivoting axle	S	
22	EC01	00310004260	Front wheel	W	
23	EC01	00310004261	Rear wheel	W	
24	EC01	00310004684	Axle for wheel	S	
25	EC01	00310004269	Blade shaft nut (7/8")	S	
26	EC01	00310004235	Drive pin (set of 10)	S	
27	EC01	00310004176	Outer collar	S	
28	EC01	00310004210	Inner collar	S	
29	EC01	00310004252	Blade shaft	S	
30	EC01	00310004196	Key	S	
31	EC01	00310004295	Bearing for blade shaft	W	
32	EC01	00310004679	Pulley and key	S	
33	EC01	00310004323	Key only	S	
34	EC01	00310004678	Bearing for cutting guide (set of 2)	W	
35	EC01	00310002084	Locking ring	S	
36	EC02	00310002136	Blade shaft cover plate	S	
37	EC02	00310004475	Belt guard	S	
38	EC02	00310312832	V Belts XPZ 850 LW (set of 4)	W	Machine 70184624214

		00310006958	V Belts XPZ 812 LW (set of 4)		Machine 70184629389
39	EC02	00310005195	Engine Honda GX 390 Cyclonic	S	
40	EC02	00310004379	Engine pulley Ø100	S	Machine 70184624214
		00310330247	Engine pulley Ø71		Machine 70184629389
41	EC01	00310004622	Wheel for cutting guide	W	
42	EC01	00310004244	Cutting guide pointer	S	
43	EC01	00310004686	Cutting guide welded	S	
44	EC01	00310004177	Spanner SW36	S	
45	EC02	00310006214	Pivoting plate motor	S	
46	EC02	00310004056	Silent block (set of 5)	S	
47	EC02	00310372339	Key engine pulley	S	
48	EC02	00310006260	Engine stop	W	
49	EC01	00310004736	Cutting guide cpl.	S	
50	EC01	00310004229	Spanner SW 17	S	
51	EC01	00310004053	Spanner SW 19	S	

(*): S = Spare part, W = Wear part

Wear parts are worn out through normal use of the machine. The wear period depends a lot on the intensity of use of the machine. Wear parts must be serviced, used and eventually changed following the indications of the manufacturer. Any wear due to normal use of the machine will not be considered as a case of warranty. Genuine Clipper replacement parts should always be used.

2 Exploded part drawings

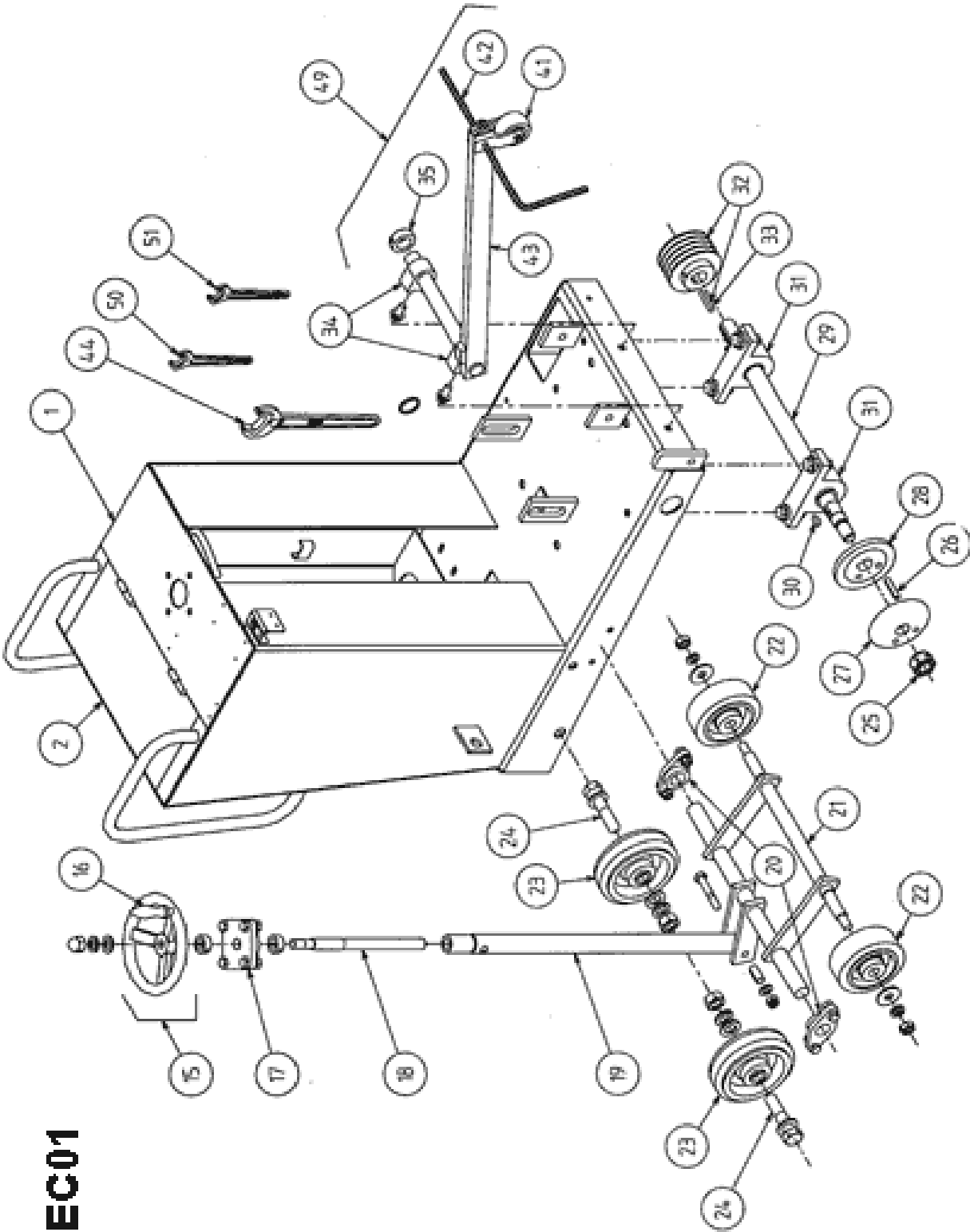

EC01

EC02

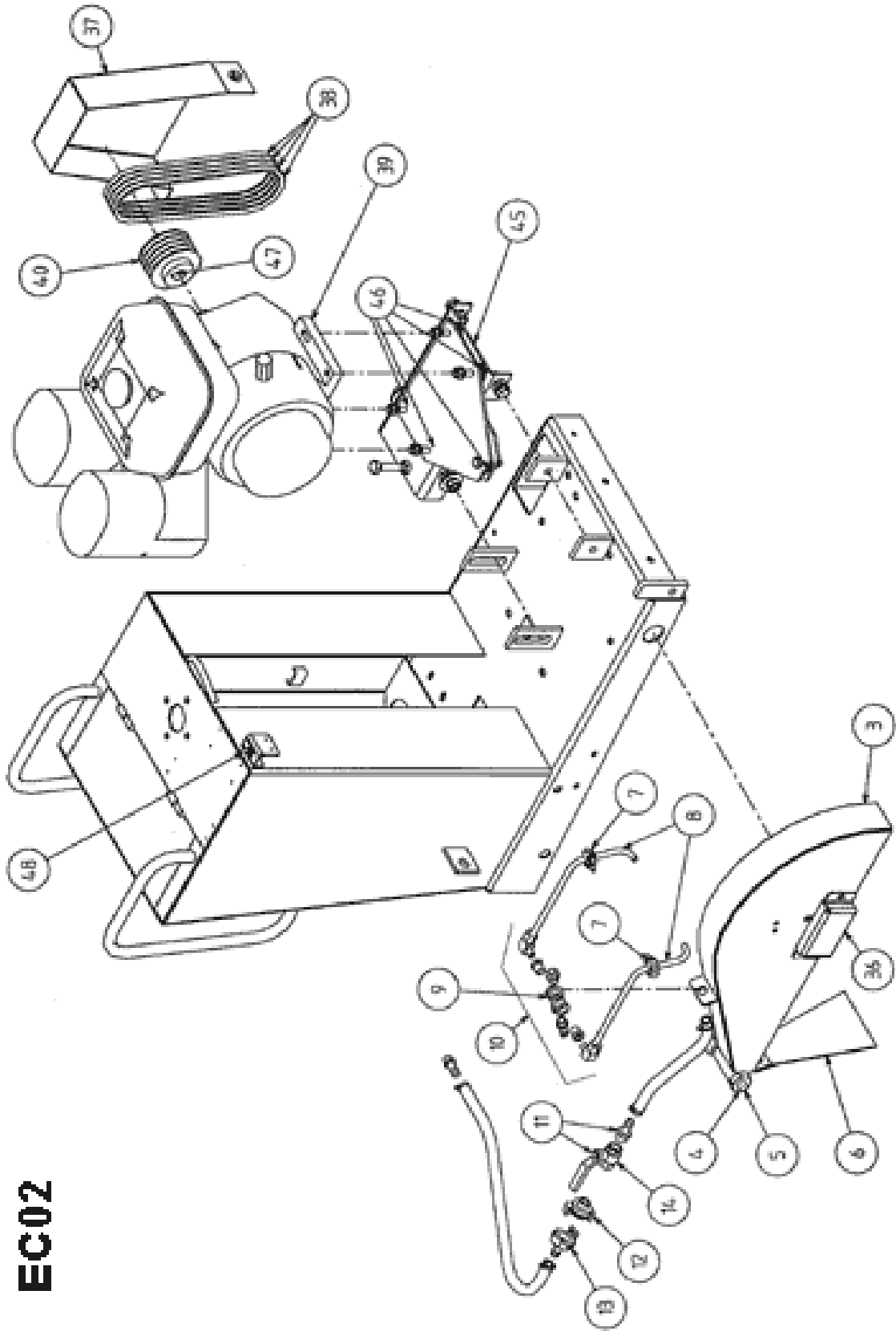



SAINT-GOBAIN ABRASIVES

190, Bd. J. F. Kennedy
L-4930 BASCHARAGE
LUXEMBOURG

Tel.: ++352 50401-1

Fax: ++352 501633

e-mail: sales.nlx@saint-gobain.com

www.construction.norton.eu

10.12.2008