

Liberator™ SS/316

Submersible De-watering Pump

Constructed from 316 Stainless Steel

T-T PUMPS®



The Liberator® is a range of stainless steel submersible pumps, which make them ideal for chemical resistant and salt water applications, as well as having the compact, light and powerful features of the standard Liberator range. They are also suitable for ground water and water containing sand and silt – maximum solids handling of 7mm.

Features

- The 316 Liberator is a complete stainless steel unit
- Compact, lightweight design
- Double mechanical seal
- Autoreset thermal protector
- 7mm solids handling
- 0.4 - 0.75kW output
- 50mm discharge

Applications

- Salt water applications
- Small water features
- Cellars and basements
- Nuisance water
- Civil construction
- Quarries and mining
- Hire fleets
- Emergencies
- De-watering

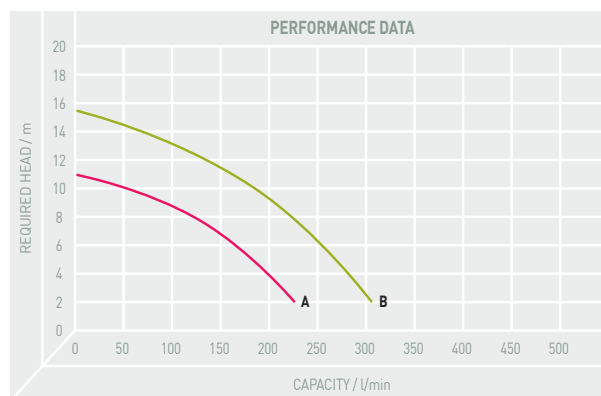

PUMP TYPE	PRODUCT CODE	OUTLET "/>mm	CURVE	KW	FREE PASSAGE mm	WEIGHT kg	CABLE LENGTH m
LIB400 230V	PH/LIB400/SS/316	2"/50mm	A	0.4	7	17	10
LIB750 230V	PH/LIB750/SS/316	2"/50mm	B	0.75	7	19	10



T-T PUMPS®

T-T Pumping Stations®

T-T Controls®

T-T Service®

T-T Agricultural & Environmental®

T-T Flow Valves®

LIBERATOR® 400/750 PARTS

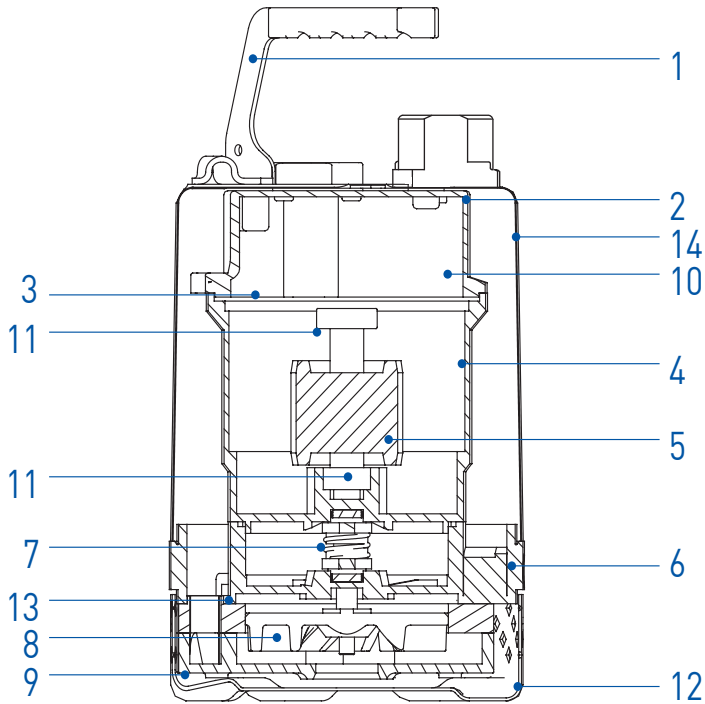

PARTS & MATERIAL LIST		
NUMBER	PART	MATERIAL
1	HANDLE	SS316
2	MOTOR COVER	SS316
3	BRACKET	SS316
4	MOTOR HOUSING & STATOR	SS316
5	SHAFT WITH ROTOR	SUS 410
6	OIL CHAMBER	SS316
7	MECHANICAL SEAL	CA / CE & SIC / SIC
8	IMPELLER	SS316
9	PUMP CASING	SS316
10	CAPACITOR	
11	BEARING	
12	STRAINER	SS316 / *NBR
13	VOLUTE LINER	NBR
14	OUTER COVER	SS316

